

BST3



Boost Timer PRO ▶

Installation and Operation Guide

Table of contents

Installation Instructions

Specifications

4

Factory Default Settings

5

Wiring Diagram

6

Caution & Safety

8

Mounting

10

Installation

11

Installation Drawings

12

Operating Instructions

How to use your Boost Timer

14

LCD Blue Back-light

15

Specifications

Power supply / Input:	230Vac 50Hz
Contact Rating:	230Vac, 50Hz, Max. 13A Resistive up to 3kW 1000W filament or halogen lighting 500W fluorescent lighting 100W LED lighting
Ambient Temperature:	0...45°C
Classification:	Type 1A Action (RL1)
Pollution degree:	Degree 2
IP rating:	IP20
Rated Impulse voltage:	Resistance to voltage surge 2500V as per EN60730
Recommended Power protection:	16A RCBO or 16A MCB & 100mA RCD where applicable

Boost Period:	15 / 30 min / 1 hr / 2 hrs / 3 hrs
Terminals suitable for:	Maximum 2.5mm ² cable
Shock protection:	Class 1
Case material:	ABS UL94V0
Timing accuracy:	Real Time Clock
Design Standard:	EN 60730-2-7

Factory Default Settings



Boost Time:	0 Minutes
Back Light:	On (BL1)

Wiring Diagram

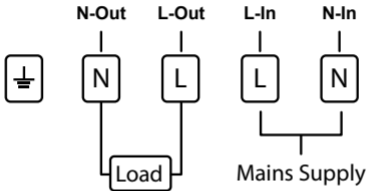

Terminal Connections

L in	Live in from Mains Supply
N in	Neutral in from Mains Supply
L out	Live out to Load
N out	Neutral out to Load
E	Earth

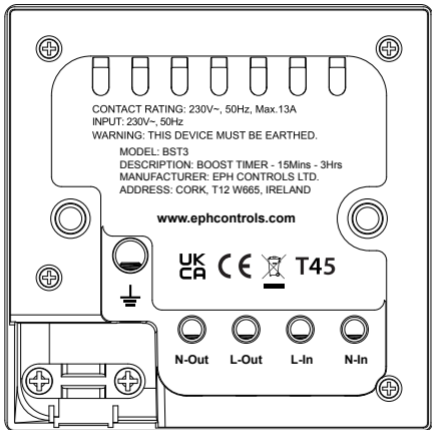

Caution!

- Installation and connection should only be carried out by a qualified person.
- Only qualified electricians or service engineers are permitted to open the Boost Timer.
- If the Boost Timer is used in a way not specified by the manufacturer, its safety may be impaired.
- Prior to setting the Boost Timer, it is necessary to complete all required settings described in the section.
- Provision must be made in the fixed wiring to incorporate a minimum 3mm contact separation in both poles of the supply.

Safety

Switch the 230V mains supply off by removing the relevant fuse or switching off the relevant MCB prior to beginning the installation.

A minimum conductor size of 2.5mm^2 must be used to supply the Boost Timer.

Ensure the correct sized cable is used to connect the Boost Timer to the relevant appliance to be switched.

For 3 kW loads, a minimum cable size of 1.5mm^2 should be used.

As per diagram on page 6 and 7.

Connect the mains supply cables to the correct terminals; L in, N in and Earth.

Connect the load cables to the correct terminals, L out, N out and Earth.

Mounting

Dimensions:	87mm x 87mm x 32mm
Flush mounted dimensions:	87mm x 87mm x 13mm
Flush mounted box depth:	Minimum 25mm
Surface mounted box depth:	Minimum 25mm

The mounting height should be 1.5 meters above floor level.

This timer can be mounted in the following ways:

1. Flush wall mounted

The Boost Timer can be mounted to any standard flush mounted single gang box provided there is a minimum depth of 25mm.

2. Surface wall mounted

The Boost Timer can be mounted to any standard surface mounted single gang box provided there is a minimum depth of 25mm.

Installation

Fix the single gang box to the wall using two fixing screws.

Connect the mains supply cable to L in, N in and Earth terminals respectively.

Connect the appliance cable to L out, N out and Earth terminals respectively.

Ensure any bare conductor is sleeved.

If the appliance cable is to exit through the front of the Boost Timer, it will be necessary to remove the breakout on the front of the Boost Timer.

Please ensure that the appliance cable is gripped with the cable clamp provided.

Fit the Boost Timer to the single gang box with the two M3.5 screws provided and ensure that no conductor is damaged in the process.

Switch on the mains and test that the Boost Timer is operational.

1

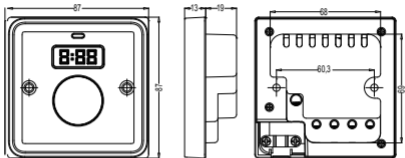

2

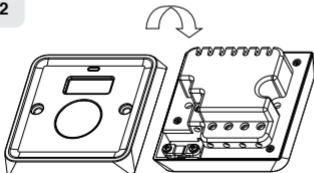
UK
CAType
1.C.Q
EN60730IP20
EN60529

3

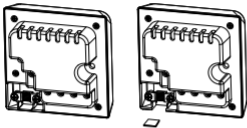

Break out

4

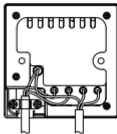

Appliance Supply

5

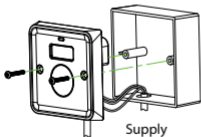

Appliance

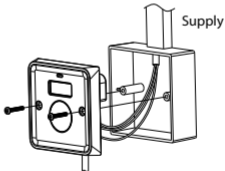

Appliance

How to use your Boost Timer

The Boost Timer can be used to switch on electrical appliances up to 3kW.

Examples of appliances that can be controlled include:
Immersion elements / Panel heaters / Lighting / Boilers etc.

By pressing the boost button:

One time - the appliance will be switched on for 15 minutes.

Two times - the appliance will be switched on for 30 minutes.

Three times - the appliance will be switched on for 1 hour.

Four times - the appliance will be switched on for 2 hours.

Five times - the appliance will be switched on for 3 hours.

To cancel the Boost Timer, simply press the Boost button again.

When the Boost is activated:

The red LED will illuminate for the boost time period.

The LCD screen will show the time the boost period is active for and will then begin to countdown the remaining time.

LCD Blue Backlight



On **BL1**

There are two options available on the Boost Timer.

To choose between having the blue backlight On or Off, simply press and hold the Boost button for 5 seconds.

BL1 – Blue Backlight On

BL0 – Blue Backlight Off

BL1 – The LCD blue backlight will illuminate for the duration of the boost time period.

BL0 – The LCD blue backlight will only illuminate for the first 5 seconds of the boost time period.

EPH Controls IE

technical@ephcontrols.com

www.ephcontrols.com

T +353 21 434 6238

F +353 21 454 5890



EPH Controls UK

technical@ephcontrols.com

www.ephcontrols.co.uk

T +44 1933 626 396

F +44 1933 626 218

